

| FOOTING SCHEDULE | | | | |
|------------------|---------------------|--------------------------------|--------|------------|
| MARK | SIZE | REINFORCING | DETAIL | T.O.F. |
| F1 | 2'-0" x 12" | (2) #5 CONT & #4 TIES 48" O.C. | S304 | 98'-6" |
| F2 | SEE DETAIL | (2) #5 CONTINUOUS | S305 | SEE DETAIL |
| F3 | 2'-6" x 2'-6" x 12" | (3) #5 BARS EACH WAY | S307 | SEE DETAIL |
| F4 | 2'-6" x 2'-6" x 12" | (3) #5 BARS EACH WAY | S308 | SEE DETAIL |
| F5 | SEE DETAIL | (2) #5 BARS CONTINUOUS | S306 | SEE DETAIL |

112 E. HARGETT STREET SUITE 200
RALEIGH NC 27601 919 821 2775

**SEISMIC REINFORCING REQ'TS
BELOW ARE FOR MACON COUNTY ONLY.**

SEISMIC REINFORCING FOR CMU WALLS

REINFORCING SHALL BE LOCATED IN ALL CMU WALLS AS FOLLOWS:
VERTICAL REINFORCING: PROVIDE #4 BAR FULL HEIGHT AT EACH CORNER OF WALLS.
 PROVIDE #4 BAR FULL HEIGHT AT EACH SIDE OF EVERY OPENING IN CMU WALLS.
 PROVIDE #4 BAR FULL HEIGHT AT THE ENDS OF ALL WALLS.
HORIZONTAL REINFORCING: PROVIDE A #4 BAR AT THE TOP AND BOTTOM OF ALL MASONRY OPENINGS EXTENDING 24" BEYOND THE OPENING ON EACH SIDE.
 THE BAR AT THE TOP OF OPENINGS MAY BE OMITTED WHERE BOND BEAM LINTELS ARE USED PROVIDED THAT THE LINTEL EXTENDS 24" BEYOND THE OPENING ON EACH SIDE.
 ALL VERTICAL REINFORCING SHALL BE PLACED IN SOLID GROUTED CORES.
 HORIZONTAL REINFORCING SHALL BE PLACED IN THE MORTAR JOINT. SEE DETAIL S102 BELOW FOR TYPICAL REINFORCING AT MASONRY OPENINGS.

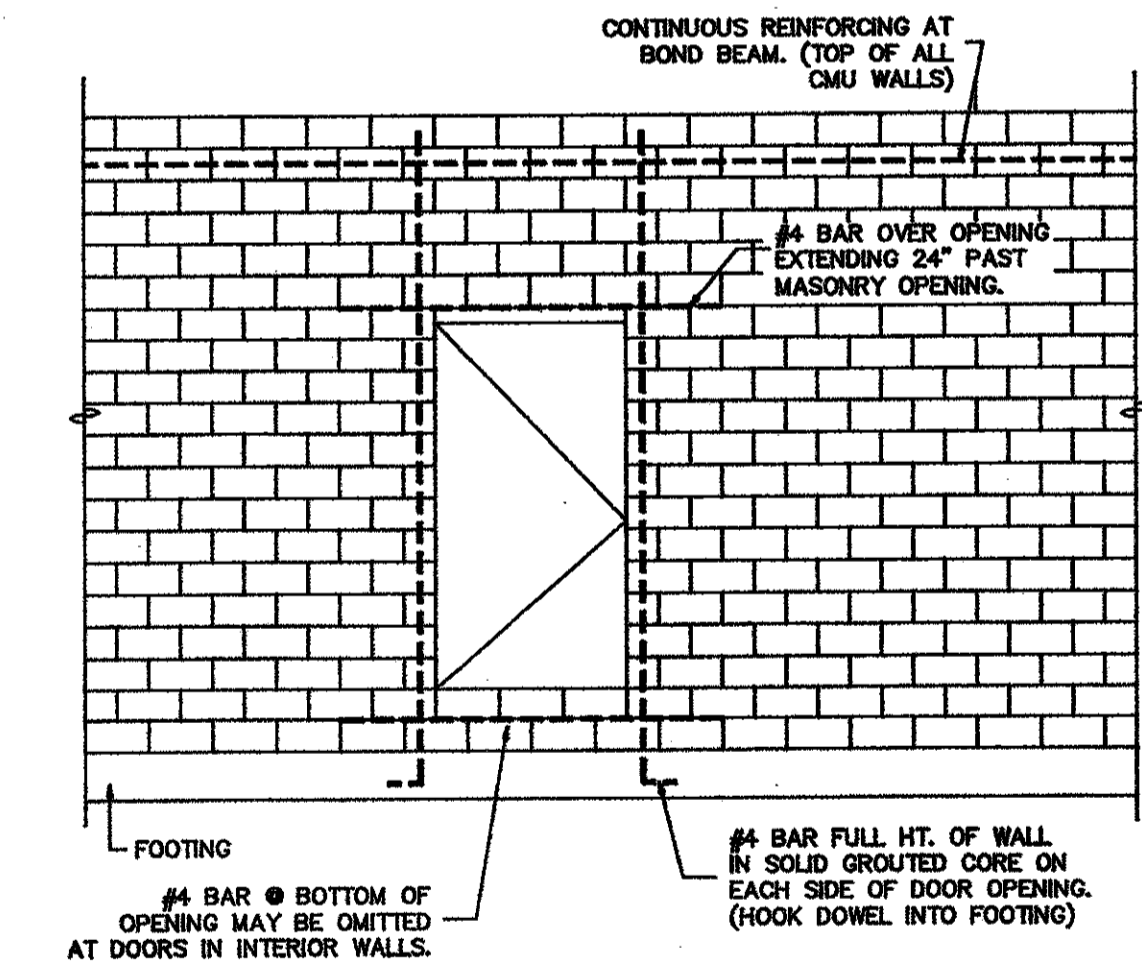

DETAIL 02 NO SCALE
SEISMIC REINFORCING @ CMU WALL OPENINGS

Record Drawings

1 October 1993

PROJECT PROTOTYPE DESIGN FOR SEVEN GROUP HOMES
LOCATION

LYSAGHT & ASSOCIATES, P.A.
STRUCTURAL ENGINEERS
120 ST. MARY'S STREET
RALEIGH NC 27605 919 833 0495

FOUNDATION PLAN 01

SCALE: 1/4" = 1'-0"

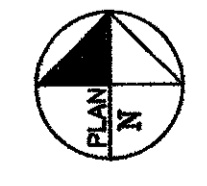

- NOTES:**
- REFERENCE FINISH FLOOR ELEVATION 100.00'. ALL ELEVATIONS ON THESE PLANS ARE REFERENCED FROM 100.00'.
 - SEE DETAIL S301 FOR TYPICAL SLAB ON GRADE CONSTRUCTION.
 - WHERE SITE CONDITIONS REQUIRE STEPPED FOOTINGS, SEE DETAIL S302. THE CONTRACTOR SHALL NOTIFY THE STRUCTURAL ENGINEER FOR A STRONGER WALL DESIGN WHEN THE HEIGHT OF UNBALANCED FILL AGAINST EXTERIOR WALLS EXCEEDS 2'-0".
 - SEE DETAIL S303 FOR MASONRY CONTROL JOINT (MCJ) CONSTRUCTION. SEE ARCHITECTURAL PLANS FOR LOCATIONS OF MCJ'S.
 - SEE THE ARCHITECTURAL PLANS FOR LOCATIONS OF INTERIOR CMU WALLS.
 - ALL COLUMNS TO BE 6x6 SOUTHERN PINE #2 TIMBER POSTS U.N.O.
 - SEE SHEET S3 FOR ADDITIONAL STRUCTURAL NOTES & SECOND FLOOR FRAMING.
 - PROVIDE CORNER BARS AT ALL FOOTING STEPS AND CORNERS. BARS SHALL BE A MINIMUM OF 2'-6" LONG AND SHALL BE THE SAME SIZE & SPACING AS PRIMARY REINFORCING. ALL SPLICES SHALL BE LAPPED 30" MINIMUM.

SHEET S1
TITLE
FOUNDATION PLAN

Date: 7/8/92
Checked: CAL
Drawn: JES